

DIST	COUNTY	ROUTE	POST MILES TOTAL PROJECT	SHEET NO.	TOTAL SHEETS

Flornie E. Baultista
 REGISTERED CIVIL ENGINEER
 No. C54859
 Exp. 6-30-18
 CIVIL
 STATE OF CALIFORNIA

January 20, 2017
 PLANS APPROVAL DATE
 THE STATE OF CALIFORNIA OR ITS OFFICERS OR AGENTS SHALL NOT BE RESPONSIBLE FOR THE ACCURACY OR COMPLETENESS OF SCANNED COPIES OF THIS PLAN SHEET.

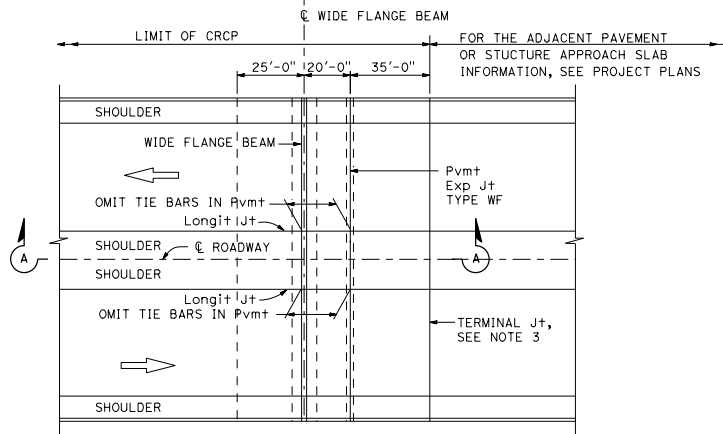

PLAN

NOTES:

1. For additional details on reinforcement member quantities of the wide flange beam terminal and Pavement Expansion Joint Type WF, see Revised Standard Plan RSP P32B.
2. For reinforcement (A), (B), and (C) Details, see Revised Standard Plan RSP P32B.
3. For the Pavement Terminal Joint Details, see Standard Plan P31A. For Pavement Terminal Joint Type, see Project Plans.
4. See Revised Standard Plan RSP P4 for "x".
5. D = Thickness of CRCP
6. See Standard Plan B6-21 for "a".

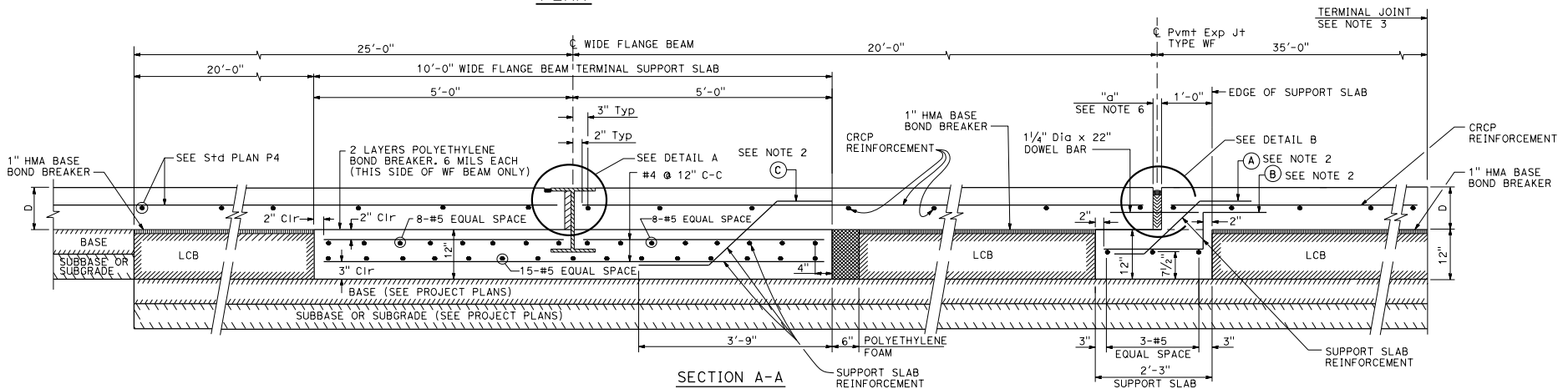

SECTION A-A

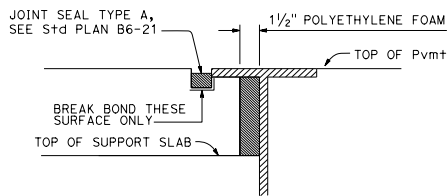

DETAIL A

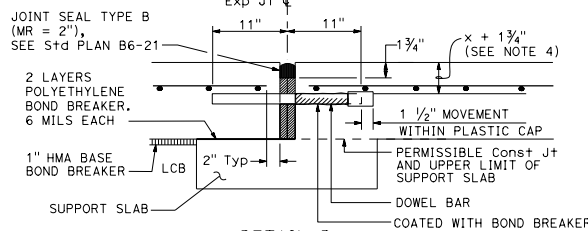

DETAIL B

For layout, tolerances, and other details not shown see Std Plan P10.

STATE OF CALIFORNIA
 DEPARTMENT OF TRANSPORTATION
**CONTINUOUSLY REINFORCED
 CONCRETE PAVEMENT -
 WIDE FLANGE BEAM TERMINALS**

NO SCALE

RSP P32A DATED JANUARY 20, 2017 SUPERSEDES RSP P32A DATED APRIL 20, 2012 SUPERSEDES STANDARD PLAN P32A DATED MAY 20, 2011 - PAGE 140 OF THE STANDARD PLANS BOOK DATED 2010.

REVISED STANDARD PLAN RSP P32A

2010 REVISED STANDARD PLAN RSP P32A