

DIST	COUNTY	ROUTE	POST MILES TOTAL PROJECT	SHEET NO.	TOTAL SHEETS

*Flornie E. Baultista*  
 REGISTERED CIVIL ENGINEER  
 No. C54859  
 Exp. 6-30-18  
 CIVIL  
 STATE OF CALIFORNIA

January 20, 2017  
 PLANS APPROVAL DATE  
 THE STATE OF CALIFORNIA OR ITS OFFICERS OR AGENTS SHALL NOT BE RESPONSIBLE FOR THE ACCURACY OR COMPLETENESS OF SCANNED COPIES OF THIS PLAN SHEET.

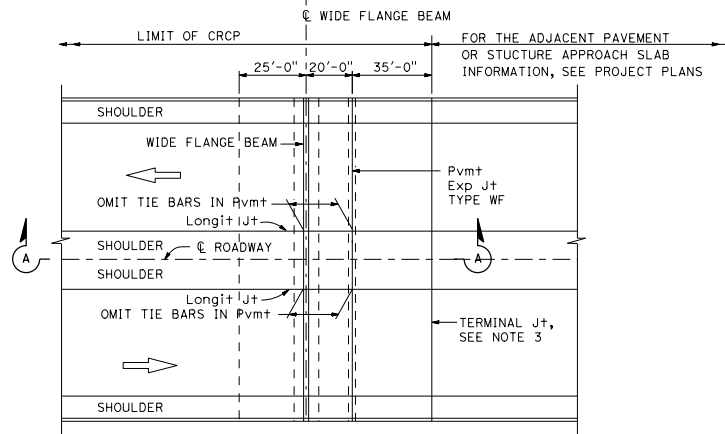

PLAN

NOTES:

- For additional details on reinforcement member quantities of the wide flange beam terminal and Pavement Expansion Joint Type WF, see Standard Plan P32B.
- For reinforcement (A), (B), and (C) Details, see Standard Plan P32B.
- For the Pavement Terminal Joint Details, see Standard Plan P31A. For Pavement Terminal Joint Type, see Project Plans.
- See Revised Standard Plan RSP P4 for "x".
- D = Thickness of CRCP
- See Standard Plan B6-21 for "a".

TO ACCOMPANY PLANS DATED \_\_\_\_\_

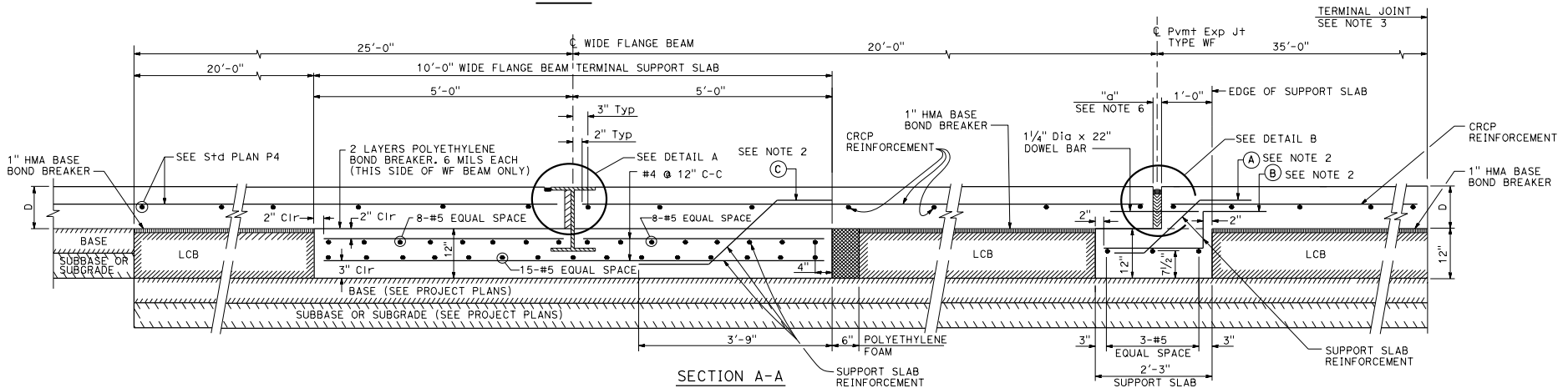

SECTION A-A

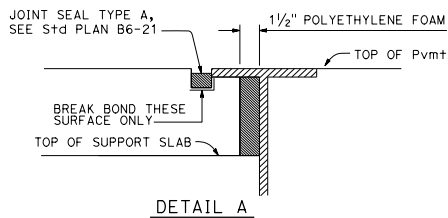

DETAIL A

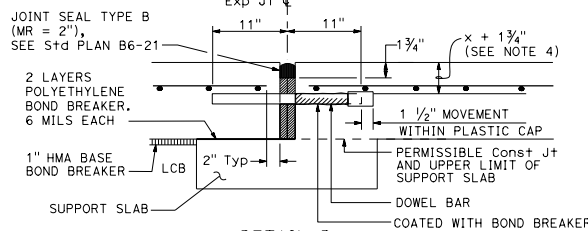

DETAIL B

For layout, tolerances, and other details not shown see Std Plan P10.

STATE OF CALIFORNIA  
 DEPARTMENT OF TRANSPORTATION  
**CONTINUOUSLY REINFORCED  
 CONCRETE PAVEMENT -  
 WIDE FLANGE BEAM TERMINALS**

NO SCALE

RSP P32A DATED JANUARY 20, 2017 SUPERSEDES STANDARD PLAN P32A  
 DATED OCTOBER 30, 2015 - PAGE 153 OF THE STANDARD PLANS BOOK DATED 2015.

**REVISED STANDARD PLAN RSP P32A**

2015 REVISED STANDARD PLAN RSP P32A