

NOTES:

See Revised Standard Plan RSP T9 for tables.
Use cone spacing X for taper segment, Y for tangent segment or Z for conflict situations, as appropriate, per Table 1, unless X, Y, or Z cone spacing is shown on this sheet.
Provide at least one person to continuously maintain traffic control devices for lane closures.

DIST	COUNTY	ROUTE	POST MILES TOTAL PROJECT	SHEET NO.	TOTAL SHEETS

REGISTERED CIVIL ENGINEER
Robert D. McNew
No. C8859
EXP. 9-30-19
STATE OF CALIFORNIA

April 20, 2018
PLANS APPROVAL DATE

THE STATE OF CALIFORNIA OR ITS OFFICERS OR AGENTS SHALL NOT BE RESPONSIBLE FOR THE ACCURACY OR COMPLETENESS OF SCANNED COPIES OF THIS PLAN SHEET.

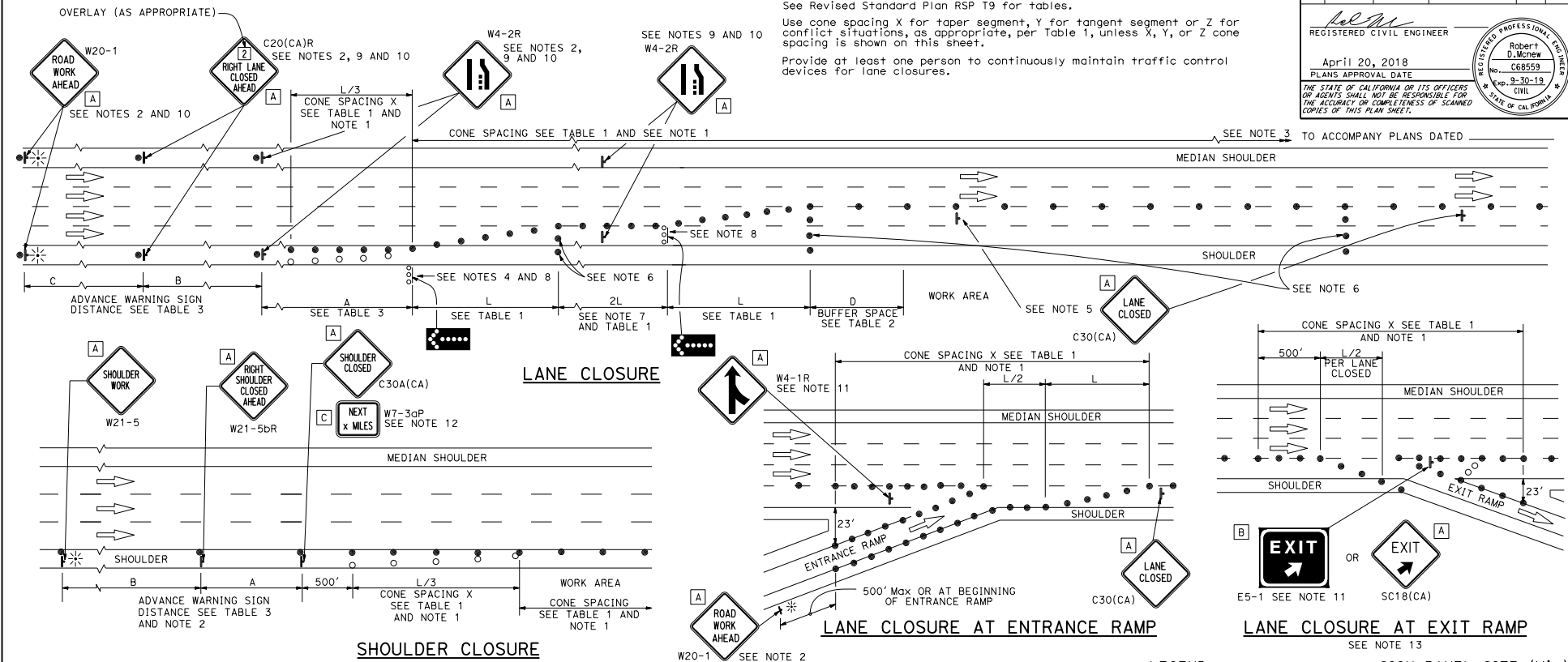

NOTES:

- Portable delineators placed at one-half the spacing indicated for traffic cones may be used instead of cones for daytime closures only.
- Each advance warning sign shall be equipped with at least two flags for daytime closure. Each flag shall be at least 16" x 16" in size and shall be orange or fluorescent red-orange in color. Flashing beacons shall be placed at the locations indicated for lane closure during hours of darkness.
- A C20-2 "END ROAD WORK" sign, with minimum size of 48" x 24" as appropriate, shall be placed at the end of the lane closure unless the end of work area is obvious or ends within the larger project's limits.
- A minimum 1500' sight distance shall be provided where possible for vehicles approaching the first flashing arrow sign. Lane closures shall not begin at the top of crest vertical curve or on a horizontal curve.
- Place a C30(CA) sign every 1000' throughout length of lane closure.
- A minimum of 3 cones shall be placed transversely across each closed lane and shoulder at each location where a taper across a traffic lane ends and every 1000' as shown on the 'Lane Closure' detail. Two type II barricades may be used instead of the 3 cones. The transverse alignment of the cones or barricades on the closed shoulder may be shifted from the transverse alignment to provide access to the work.
- The 2L tangent shown along lane lines shall be used between the L tapers required for each closed traffic lane.
- Use one flashing arrow sign for each lane closed. The flashing arrow sign shall be Type I.
- Median lane closures shall conform to the details as shown except that C20(CA)L and W4-2L signs shall be used.
- Duplicate sign installations are not required:
 - On opposite shoulder if at least one-half of the available lanes remain open to traffic.
 - In the median if the width of the median shoulder is less than 8' and the outside lanes are to be closed.
- The E5-1 or SC18(CA) and W4-1 signs shall be used as shown.
- A W7-3aP "NEXT MILES" plaque must be used if the shoulder closure extends beyond the distance that can be perceived by road users.
- For the warning sign requirements at the Exit Ramp, when work is proposed on the local street, see CA MUTCD Figure 6H-22 to 6H-27.

LEGEND

- TRAFFIC CONE
- TRAFFIC CONE (OPTIONAL TAPER)
- ↑ TEMPORARY TRAFFIC CONTROL SIGN
- ⬢ FLASHING ARROW SIGN (FAS)
- ☞ FAS SUPPORT OR TRAILER
- ☼ PORTABLE FLASHING BEACON

SIGN PANEL SIZE (Min)

- A 48" x 48"
- B 72" x 60"
- C 36" x 30"

STATE OF CALIFORNIA
DEPARTMENT OF TRANSPORTATION
**TRAFFIC CONTROL SYSTEM
FOR LANE CLOSURE ON
FREEWAYS AND EXPRESSWAYS**
NO SCALE

RSP T10 DATED APRIL 20, 2018 SUPERSEDES RSP T10 DATED JANUARY 20, 2017 AND STANDARD PLAN T10 DATED OCTOBER 30, 2015 - PAGE 250 OF THE STANDARD PLANS BOOK DATED 2015.

REVISED STANDARD PLAN RSP T10

2015 REVISED STANDARD PLAN RSP T10