

DIST	COUNTY	ROUTE	POST MILES TOTAL PROJECT	SHEET NO.	TOTAL SHEETS
					
REGISTERED ELECTRICAL ENGINEER October 19, 2018 PLANS APPROVAL DATE THE STATE OF CALIFORNIA OR ITS OFFICERS OR AGENTS SHALL NOT BE RESPONSIBLE FOR THE ACCURACY OR COMPLETENESS OF SCANNED COPIES OF THIS PLAN SHEET.					

TO ACCOMPANY PLANS DATED _____

NOTES:

1. Round corners of acute angle saw cuts to prevent damage to conductors.
2. Typical distance separating loops from edge is 10' for Type A, B, D, E, and F installation in single lane.
3. Use Type D and F loops for limit line detection and bicycle lanes.

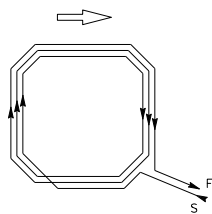

WINDING DETAIL
TYPE A LOOP DETECTOR CONFIGURATION

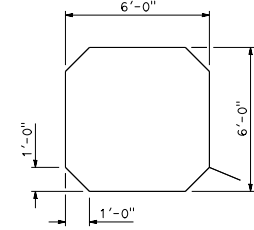

SAW CUT DETAIL

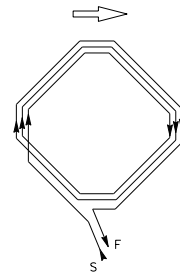

WINDING DETAIL
TYPE B LOOP DETECTOR CONFIGURATION

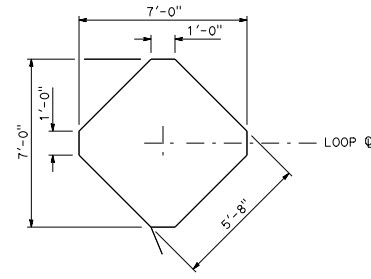

SAW CUT DETAIL

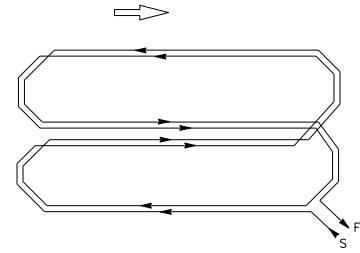

WINDING DETAIL
TYPE C LOOP DETECTOR CONFIGURATION

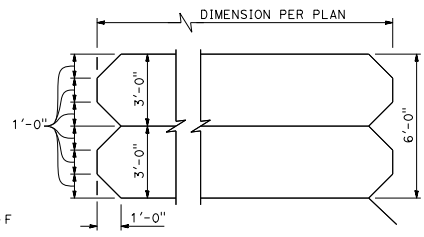

SAW CUT DETAIL

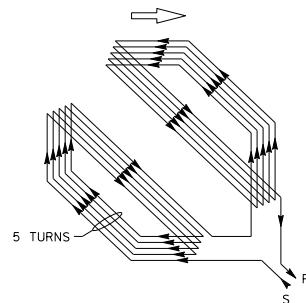

WINDING DETAIL
TYPE D LOOP DETECTOR CONFIGURATION

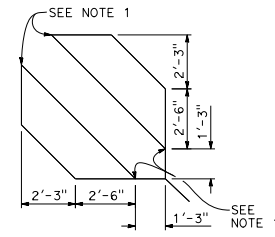

SAW CUT DETAIL

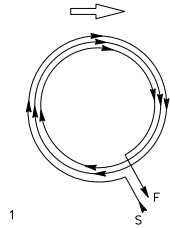

WINDING DETAIL
TYPE E LOOP DETECTOR CONFIGURATION

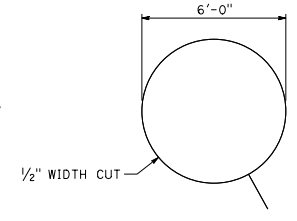

SAW CUT DETAIL

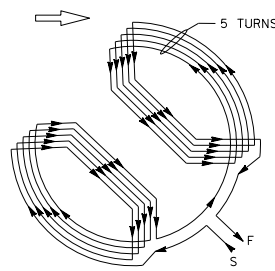

WINDING DETAIL
TYPE F LOOP DETECTOR CONFIGURATION

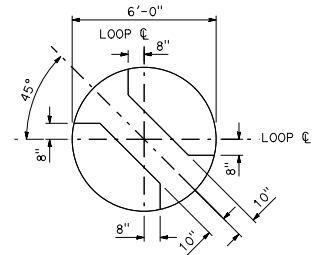

SAW CUT DETAIL

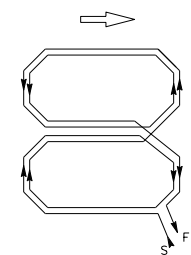

WINDING DETAIL
TYPE Q LOOP DETECTOR CONFIGURATION

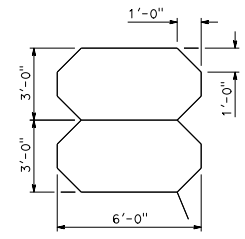

SAW CUT DETAIL

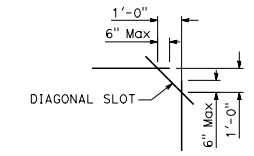

PLAN VIEW OF
DIAGONAL SLOT
AT CORNERS

STATE OF CALIFORNIA
DEPARTMENT OF TRANSPORTATION
**ELECTRICAL SYSTEMS
(DETECTORS)**

NO SCALE

RSP ES-5B DATED OCTOBER 19, 2018 SUPERSEDES STANDARD PLAN ES-5B
DATED MAY 31, 2018- PAGE 505 OF THE STANDARD PLANS BOOK DATED 2018.

REVISED STANDARD PLAN RSP ES-5B

2018 REVISED STANDARD PLAN RSP ES-5B