

NOTES:

See Standard Plan T9 for tables.  
 Use cone spacing X for taper segment, Y for tangent segment or Z for conflict situations, as appropriate, per Table 1, unless X, Y, or Z cone spacing is shown on this sheet.  
 Provide at least one person to continuously maintain traffic control devices for lane closures.

Dist*	COUNTY	ROUTE	POST MILES TOTAL PROJECT	SHEET NO.	TOTAL SHEETS

*Atifa Ferouz*  
 REGISTERED CIVIL ENGINEER  
 No. C80402  
 Exp. 3-31-19  
 CIVIL  
 STATE OF CALIFORNIA

May 31, 2018  
 PLANS APPROVAL DATE

THE STATE OF CALIFORNIA OR ITS OFFICERS OR AGENTS SHALL NOT BE RESPONSIBLE FOR THE ACCURACY OR COMPLETENESS OF SCANNED COPIES OF THIS PLAN SHEET.

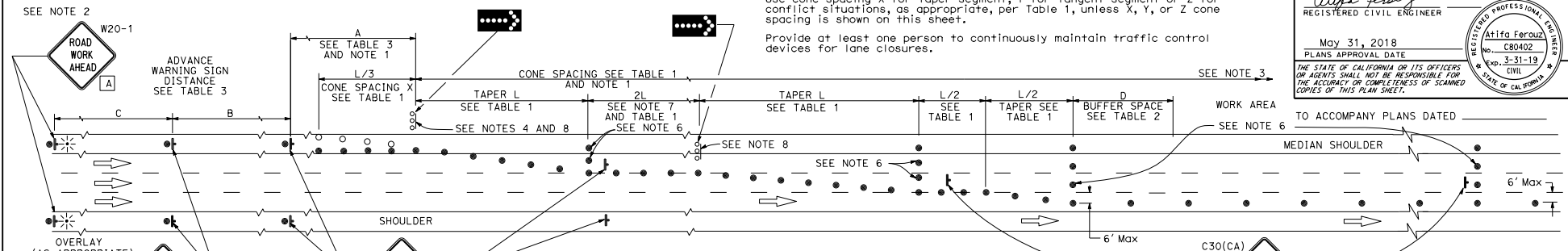

LANE CLOSURE WITH PARTIAL SHOULDER USE

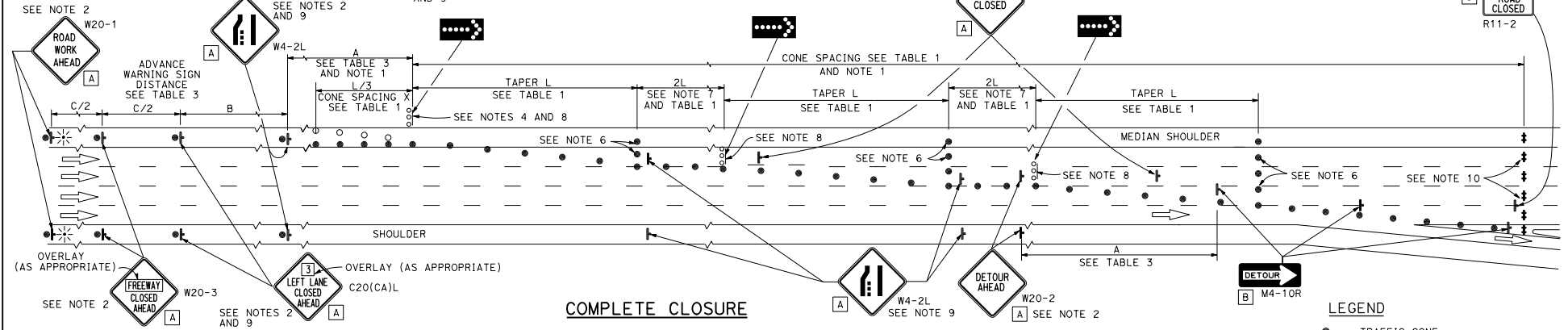

COMPLETE CLOSURE

NOTES:

- Portable delineators placed at one-half the spacing indicated for traffic cones may be used instead of cones for daytime closures only.
- Each advance warning sign shall be equipped with at least two flags for daytime closure. Each flag shall be at least 16" x 16" in size and shall be orange or fluorescent red-orange in color. Flashing beacons shall be placed at the locations indicated for lane closure during hours of darkness.
- A G20-2 "END ROAD WORK" sign, with minimum size of 48" x 24" as appropriate, shall be placed at the end of the lane closure unless the end of work area is obvious or ends within a larger project's limits.
- A minimum 1500' of sight distance shall be provided where possible for vehicles approaching the first flashing arrow sign. Lane closures shall not begin at the top of crest vertical curve or on a horizontal curve.
- Place a C30(CA) sign every 1000' throughout length of lane closure.
- A minimum of 3 cones shall be placed transversely across each closed lane and shoulder at each location where a taper across a traffic lane ends and every 1000' as shown on the "Lane Closure with Partial Shoulder Use" detail. Two type II barricades may be used instead of the 3 cones. The transverse alignment of the cones or barricades on the closed shoulder may be shifted from the transverse alignment to provide access to the work.
- The 2L tangent shown along lane lines shall be used between the L tapers required for each closed traffic lane.
- Use one flashing arrow sign for each lane closed. The flashing arrow sign shall be Type I.
- Lane closures on the right side using partial median shoulder as a traffic lane shall conform to the details shown except that C20(CA)R and W4-2R signs shall be used.
- A minimum of Two Type II or III barricades shall be placed across each closed lane and shoulder at the location shown and every 2000' within the complete closure area. Within the complete closure area, the transverse alignment of the barricades on the closed shoulder may be shifted from the transverse alignment to provide access to the work.

SIGN PANEL SIZE (Min)

- A 48" x 48"
- B 48" x 18"
- C 48" x 30"

LEGEND

- TRAFFIC CONE
- TRAFFIC CONE (OPTIONAL TAPER)
- ⊥ TEMPORARY TRAFFIC CONTROL SIGN
- ⬇ FLASHING ARROW SIGN (FAS)
- ⊞ FAS SUPPORT OR TRAILER
- ⊛ PORTABLE FLASHING BEACON

STATE OF CALIFORNIA  
 DEPARTMENT OF TRANSPORTATION

**TRAFFIC CONTROL SYSTEM  
 FOR LANE CLOSURE ON  
 FREEWAYS AND EXPRESSWAYS**

NO SCALE

T10A